

1x30W TRI COB 25°/80° LED PROJECTOR

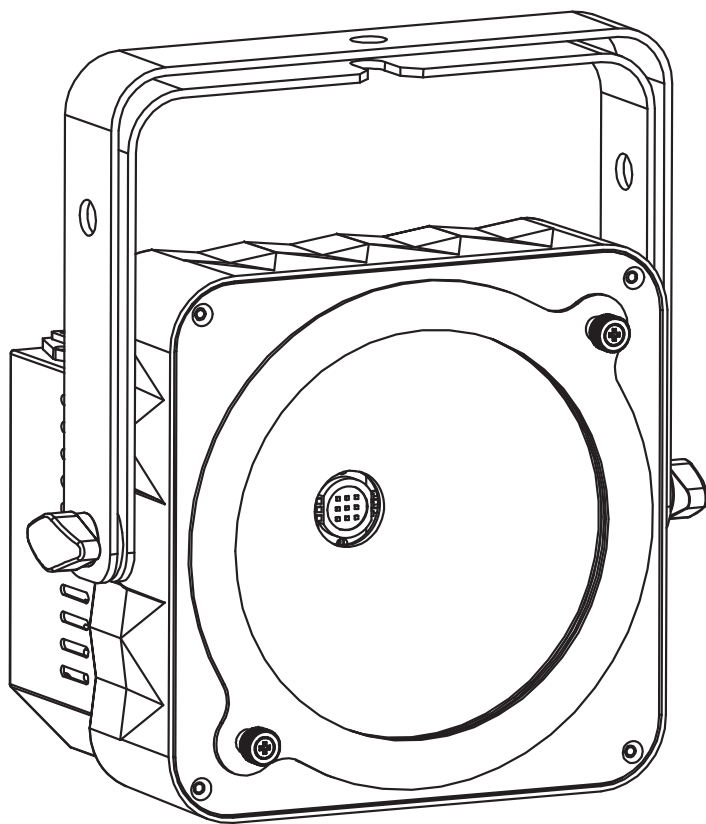

irLEDFLAT

1x30TCb

USER GUIDE
10130 - Version 1 / 10-2013

1 - Safety information

Important safety information



This unit is intended for indoor use only. Do not use it in a wet, or extremely cold/hot locations. Failure to follow these safety instructions could result in fire, electric shock, injury, or damage to this product or other property.



This product contains non-isolated electrical components. Do not undertake any maintenance operation when it is switched on as it may result in electric shock.



Any maintenance procedure must be performed by a CONTEST authorised technical service. Basic cleaning operations must thoroughly follow our safety instructions.



CAUTION
RISK OF ELECTRIC SHOCK
DO NOT OPEN



WARNING : This unit contains no user-serviceable parts. Do not open the housing or attempt any maintenance by yourself. In the unlikely even your unit may require service, please contact your nearest dealer. In order to avoid any electrical malfunction, please do not use any multi-socket, power cord extension or connecting system without making sure they are perfectly isolated and present no defect.



Warning

This product is equipped with Class 2 LEDs. Please avoid looking directly at the beam as it may cause severe eye injuries.



Risk of electrocution

To prevent the hazard of electric shocks, do not use extension cords, multi-socket or any other connection system without making sure metal parts completely are out of reach.



Recycling your device

- As HITMUSIC is really involved in the environmental cause, we only commercialise clean, ROHS compliant products.
- When this product reaches its end of life, take it to a collection point designated by local authorities. The separate collection and recycling of your product at the time of disposal will help conserve natural resources and ensure that it is recycled in a manner that protects human health and the environment.

Symbols used



This symbol signals an important safety precaution.



The CAUTION symbol signals a risk of product deterioration.



The WARNING symbol signals a risk to the user's physical integrity. The product may also be damaged.



Note : The legislation requires that every device set up in a public space features a double fixation bracket. This security system must hold 10 times the weight of the device.

Instructions and recommendations

1 - Please read carefully :

We strongly recommend to read carefully and understand the safety instructions before attempting to operate this unit.

2 - Please keep this manual :

We strongly recommend to keep this manual with the unit for future reference.

3 - Operate carefully this product :

We strongly recommend to take into consideration every safety instruction.

4 - Follow the instructions:

Please carefully follow each safety instruction to avoid any physical harm or property damage.

5 - Avoid water and wet locations :

Do not use this product in rain, or near washbasins or other wet locations.

6 - Installation :



We strongly encourage you to only use a fixation system or support recommended by the manufacturer or supplied with this product. Carefully follow the installation instructions and use the adequate tools.

Always ensure this unit is firmly fixed to avoid vibration and slipping while operating as it may result in physical injury.

7 - Ceiling or wall installation :

Please contact your local dealer before attempting any ceiling or wall installation.

8 - Ventilation :

The cooling vents ensure a safe use of this product, and avoid any overheating risk.

Do not obstruct or cover these vents as it may result in overheating and potential physical injury or product damage. This product should never be operated in a closed non-ventilated area such as a flight case or a rack, unless cooling vents are provided for the purpose .

9 - Heat exposure :

Sustained contact or proximity with warm surfaces may cause overheating and product damages. Please keep this product away from any heat source such as a heaters, amplifiers, hot plates, etc...

10 - Electric power supply :



This product can only be operated according to a very specific voltage. These information are specified on the label located at the rear of the product.

11 - Power cords protection:



Power-supply cords should be routed so that they are not likely to be walked on or pinched by items placed upon or against them, paying particular attention to cords at lugs, convenience receptacles and the point where they exit from the fixture.

12 - Cleaning precautions :



Unplug the product before attempting any cleaning operation. This product should be cleaned only with accessories recommended by the manufacturer. Use a damp cloth to clean the surface. Do not wash this product.

13 - Long periods of non use :



Disconnect the unit's main power during long periods of non use.

14 - Liquids or objects penetration :



Do not let any object penetrate this product as it may result in electric shock or fire.

Never spill any liquid on this product as it may infiltrate the electronic components and result in electric shock or fire.

15 - This product should be serviced when :



Please contact the qualified service personnel if :

- The power cord or the plug has been damaged.
- Objects have fallen or liquid has been spilled into the appliance.
- The appliance has been exposed to rain or water.
- The product does not appear to operate normally.
- The product has been damaged.

16 - Inspection/maintenance :

Please do not attempt any inspection or maintenance by yourself. Refer all servicing to qualified personnel.

17 - Operating environment :



Ambient temperature and humidity: +5 - +35°C, relative humidity must be less than 85% (when cooling vents are not obstructed).

Do not operate this product in a non-ventilated, very humid or warm place..

2 - Main characteristics

• Features:

- Metal housing
- Double holding brackets for ground and aerial use
- Rear display
- Frost filter allowing a 80° beam aperture angle
- Internal thermal protection

• Functions:

- Built-in command panel with digital drop-down display for:
 - DMX addressing
 - Choosing the number of channels: 2, 3, 4, 5 or 6
 - Choosing the built-in programs
 - Choosing the preset colours
 - Master/slave mode
 - Music-sensitive mode and choosing the mic sensitivity
 - Accessing the user program

• Package contents:

The package must contain the following products:

- A projector
- A Frost filter
- A user guide
- A double holding bracket
- A 2-pole + earth IEC power cord

3 - Technical specifications

- 1x30W TRI COB LED – 30,000 hours
- Beamwidth : 25°
- The Frost filter allows a 80° beam aperture angle
- Light output: 413 Lux at 3m
- 20-step customisable user program
- Power consumption: 45W
- Power supply: AC 100/240V - 50/60Hz
- Power input/output
- DMX input/output
- Double holding bracket
- Dimensions: 208 x 221 x 120 mm
- Net weight: 2.1 Kg

4 - Description du panneau arrière

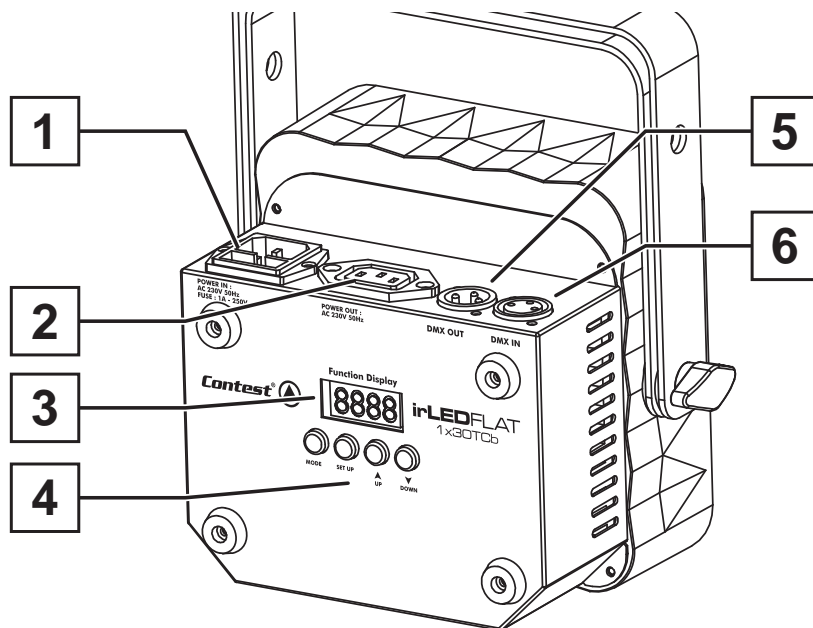

1 Power input socket

Allows you to connect the projector to an electrical outlet. Please make sure the voltage is in adequation with the product indications.

Fuse: If need to replace the fuse, please make sure the new fuse has exactly the same characteristics as the original one.

2 Power output socket

Allows you to link several projectors together via a Male/Female IEC cord.

3 Display

This intuitive display allows you to configure your projector. Please refer to the next paragraphs for more details about the projector configuration. . The display automatically shuts off after 30 seconds of inactivity.

4 Menu buttons

MODE button

Allows you to access menus and select a function

SETUP button

Allows you to configure the parameters of the functions chosen with the MODE button.

UP and DOWN Buttons

Allows you to increase or decrease selected values.

5 DMX output

3-pin male XLR plug hardwired as follows :

- Mass: 1
- Negative signal: 2
- Positive signal: 3

6 DMX input

3-pin female XLR plug hardwired as follows :

- Mass: 1
- Negative signal: 2
- Positive signal: 3

5 - Internal menu

Access the internal menu by pressing **MODE**.

To access a submenu, press **MODE** again.

If you want the display to lit off when the menu remains inactive for more than 20 seconds, press simultaneously **MODE** and **DOWN**.

Mode	SETUP	UP and DOWN	Action
DMX modes			3 channels: RGB dimmers
			4 channels: RGB dimmers / Main dimmer, Strobe
			2 channels: Fixed colours, Macros / Main dimmer, Strobe
			5 channels: RGB dimmers / Dimmer / Strobe
			6 channels: RGB dimmers / Main dimmer / Speed, Strobe / Fixed colours, Macros, Music-sensitive mode
	DMX address		DMX addressing
Fixed colours and macros	Colour		Black-out, Colours 1 to 10 and 6 macros
	Strobe		Strobe speed : FS.00 = No strobe ; FS.99 = Full speed
	Speed		Macros speed
RGB dimmers (Manual mode)			Red: 0 - 100%
			Green: 0 - 100%
			Blue: 0 - 100%
			Strobe speed : FS.00 = No strobe ; FS.99 = Full speed
Auto mode			Strobe speed : FS.00 = No strobe ; FS.99 = Full speed
Music-sensitive mode			SU.00 = min sensitivity ; SU.31 = max sensitivity
Slave mode			Activates the slave mode
Playing the user program			Plays or stops the user program
			Configures the main speed for every step
			Configures the crossfading for every step
			Configures the strobe speed for every step
			Configures the main dimmer for every step

User program edition	<div>Edit</div>	<div>SC01SC20</div>	Allows you to choose the max number of scenes : 1 - 20 total
		<div>SE01SE20</div>	Scene you are currently editing
		<div>R000R255</div>	Red level settings of the selected scene
		<div>G000G255</div>	Green level settings of the selected scene
		<div>B000B255</div>	Blue level settings of the selected scene

6 - The various DMX modes

6.1 - 3-channel mode: R / G / B =

CH3

	DMX	Effect
Channel 1	000 - 255	Red: 0 - 100%
Channel 2	000 - 255	Green: 0 - 100%
Channel 3	000 - 255	Blue: 0 - 100%

6.2 - 4-channel mode: R / G / B / Dimmer and Strobe =

CH4

	DMX	Effect
Channel 1	000 - 255	Red: 0 - 100%
Channel 2	000 - 255	Green: 0 - 100%
Channel 3	000 - 255	Blue: 0 - 100%
Channel 4	000 - 189	Main dimmer; 0-100%
	190 - 250	Strobe speed
	251 - 255	Full power

6.3 - 2-channel mode : Fixed colours, Macros / Dimmer, Speed or music-sensitive mode = CHC2

Channel 1		Channel 2
000 - 015	Off (LEDs éteintes)	000 - 255 Dimmer : 0 - 100%
016 - 030	Red	
031 - 045	Orange	
046 - 060	Yellow	
061 - 075	Green	
076 - 090	Cyan	
091 - 105	Blue	
106 - 120	Pink	
121 - 135	Magenta	
136 - 150	Cool white (6000°K)	
151 - 165	Warm white (3200°K)	000 - 255 Macros speed
166 - 178	Macro 1	
179 - 191	Macro 2	
192 - 204	Macro 3	
205 - 217	Macro 4	
218 - 230	Macro 5	
231 - 243	Macro 6	000 - 255 Mic sensitivity
244 - 255	Music-sensitive mode (only for Macro 1)	

6.4 - 5-channel mode: R / G / B / Dimmer / Strobe = CHd5

	DMX	Effect
CHANNEL 1	000 - 255	Red: 0 - 100%
CHANNEL 2	000 - 255	Green: 0 - 100%
CHANNEL 3	000 - 255	Blue: 0 - 100%
CHANNEL 4	000 - 255	Main dimmer: 0-100%
CHANNEL 5	000	No function
	001 - 255	Strobe speed

6.5 - 6-channel mode = R / G / B / Dimmer / Speed, Strobe / Fixed colours, Macros, Music-sensitive mode = CHEG

Channel 6			Channel 5	Channel 4	Channel 3	Channel 2	Channel 1				
1	000 - 015	Black-out	Strobe (000 - 255)	Main dimmer (000 - 255)	Blue (000 - 255) 0 to 100%	White (000 - 255) 0 to 100%	Red (000 - 255) 0 to 100%				
2	016 - 030	Red			No function	No function	No function				
3	031 - 045	Orange									
4	046 - 050	Yellow									
5	061 - 075	Green									
6	076 - 090	Cyan									
7	091 - 105	Blue									
8	106 - 120	Pink									
9	121 - 135	Magenta									
10	136 - 150	Cool white									
11	151 - 165	Warm white									
12	166 - 178	Macro 1	Speed (000 - 255)								
13	179 - 191	Macro 2									
14	192 - 204	Macro 3									
15	205- 217	Macro 4									
16	218 - 230	Macro 5									
17	231 - 243	Macro 6									
18	244 - 255	Music-sensitive mode (only for Macro 1	Mic sensitivity 000 - 255								

7 - Dimensions

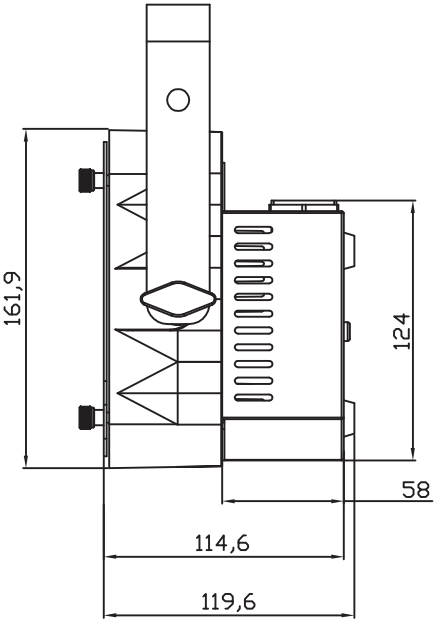
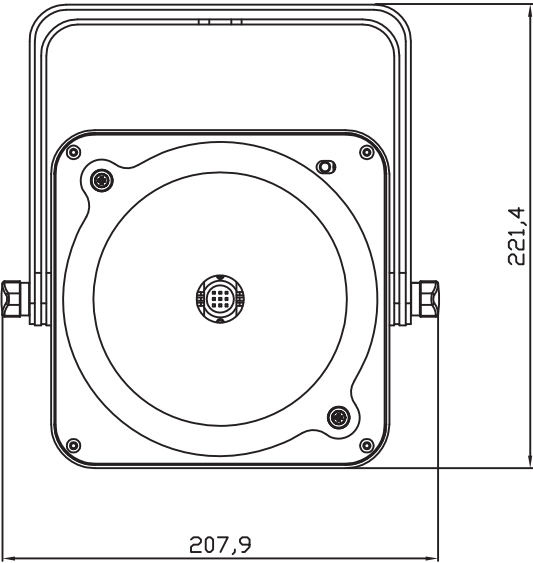

8 - Notes

Because CONTEST® takes the utmost care in its products to make sure you only get the best possible quality, our products are subjects to modifications without prior notice. That is why technical specifications and the products physical configuration might differ from the illustrations.
Make sure you get the latest news and updates about the CONTEST® products on www.contest-lighting.com
CONTEST® is a trademark of HITMUSIC S.A. - Zone Cahors sud - 46230 FONTANES - FRANCE